

All dimensions to be checked on site prior to the commencement of construction. All dimensions are to structure and any discrepancy should be reported to the architect immediately. This drawing may NOT be reproduced in any part or form without written consent from Fulcrum Design Ltd. Subcontractor MUST ensure that they have the latest issued drawing before they commence work on site.

**KEY**

- SVP Soil & vent pipe 110mm dia
  - RWP Rain water downpipe
  - BIG Back inlet gully
  - SSA Silt stack filled with air admittance valve
  - DDC Direct drain connection
  - MVJ Movement joint
  - OTG Outside tap with back inlet gully
  - OUT Outside tap
  - CCR Proprietary insulated cavity closer to all external reveals
  - CBW Carry barner
  - LBW Lathboarding wall
  - BSB Boiler flue with roof seal
  - OSP Gas point
  - AGV Automatic opening ventilator
  - RAO Radiator
  - BFT Boiler flue terminal
  - HTR Heated towel rail
  - OGW Obscure glazed window
  - LH Insulated loft hatch
- Mechanical Extraction**
- MEU Mechanical extract fan terminal from utility room min extract rate 30 litres / sec
  - MEC Mechanical extract fan terminal from kitchen min extract rate 15 litres / sec
  - MEB Mechanical extract fan terminal from bathroom min extract rate 15 litres / sec
  - MEH Mechanical extract fan terminal from cooker hood min extract rate 30 litres / sec
- Doors**
- ☐ Door leaf shown thus indicates non fire resistant door
  - ◼ Door leaf shown thus indicates 30/30 fire resistant door
  - ◼ Door leaf shown thus indicates 60/60 fire resistant door and filled with smoke seals.
- Ref Door sizes**
- D1 864 x 1981mm
  - D2 839 x 1981mm
  - D3 782 x 1981mm
  - D4 666 x 1981mm
  - D5 610 x 1981mm
  - D6 533 x 1981mm
  - D7 457 x 1981mm
  - D8 Pair of 638 x 1981mm
  - D9 Pair of 762 x 1981mm
  - D10 Pair of 688 x 1981mm
  - D11 Pair of 610 x 1981mm
  - D12 Pair of 532 x 1981mm
  - D13 Pair of 457 x 1981mm
- Block / Blockwork Hatching**
- ▨ Facing Blockwork
  - ▨ 3.5kN/m Lightweight concrete blockwork
  - ▨ 2kN/m Lightweight concrete blockwork
  - ▨ 10kN/m Lightweight concrete blockwork

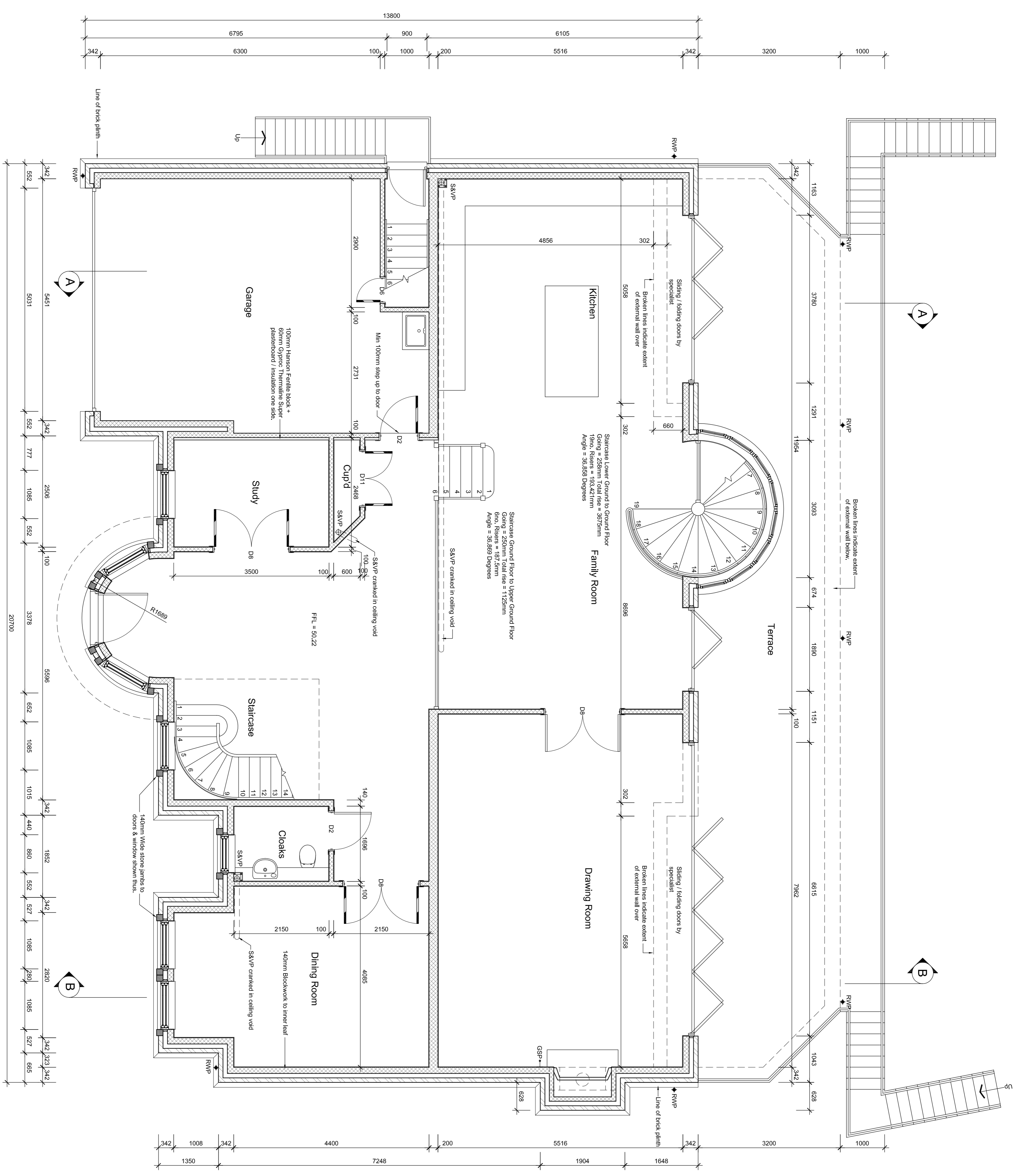

**GROUND FLOOR PLAN**

**Client**  
Sycamore Developments

**Title**  
Ground Floor Plan

**Project**  
35 Pelhams Walk  
Essex  
Surrey

**Scale**  
1:50 @ A1

**Date**  
03/04/08

**Drawn by**  
DWF

**Rev**  
07 14 102 J

**fulcrum design**

Scale 7 Tenthings  
Gulford Road, Bishops  
Cleeve, Cheltenham  
Tel 01235 414248  
Fax 01232 498430  
Email info@fulcrumdesign.co.uk  
www.fulcrumdesign.co.uk